









wünder|TILE™

XL composite tile panel

Installation Manual

Manual Contents:

-  1.1W - Materials, Tools, Safety
-  2.1W - Product Limitations & General Requirements
-  3.1W - How to Cut & Drill
-  4.1W - How to Mitre
-  5.1W - Using Edge Profiles
-  6.1W - How to Adhere
-  7.1W - Installing Wundertile
-  8.1W - Cleaning and Maintenance
-  9.1W - Warranty



The information within this guide is for reference only and does not supersede requirements from other product manufacturers or building codes.

Consult and follow manufacturers specific installation and safety instructions.

Wundertile™ is a division of the Rudiger Group Inc. Rudiger Group Inc bears no responsibility or liability for damage(s) resulting from the product installation.

All tasks performed by the product user are at the own risk and liability of the user.

Information may change without notice. Visit www.wundertile.ca for most current revision of document.

No portion(s) of this document may be copied or used without prior written consent from Rudiger Group Inc. Rudiger Group Inc. All Rights Reserved 2024.

1.1W - Required Products, Tools, Materials & Safety

Wündertile Panel



Wündertile™ Panel, 3mm (1/8") thick



metal edge profile



magnetic aligning strip

Tools



Tape Measure



Marker / Pencil



300ml Caulking Gun



Rare Earth Magnet for panel alignment.

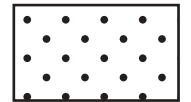

220grit Foam Backed Sandpaper



Track Saw & Track

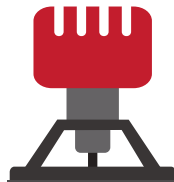

Router



Fine tooth bi-metal Holesaw



Jigsaw

Adhesive & Seams



For JOINTS / SEAMS:
Laticrete® Latasil®
Colored Silicone



For BONDING PANELS:
Silco RTV-7500



Painters
Tape



Silicone
Primer

Safety (see MSDS listed on website)



2.1W - Product Limitations and General Requirements

- Wundertile panels must be installed in accordance with the most current Installation Manual to be eligible for warranty. Warranty details and most current Installation Manual are available at www.wundertile.ca
- **Wundertile panels are for wall use only.**
- Wundertile panels are not tested for Steam Shower use.
- Wundertile panels are for interior use only, with an operating range of -20°C to +70°C.
- If using around or behind a fireplace (example zero clearance gas fireplace), ensure the maximum temperature of the Wundertile does not exceed +70°C .
- The wall framework must be 16" O.C constructed to meet local building code, with a minimum 1/2" thick (12.7mm) backerboard fastened to the framework. The assembly must be able to support and bond the finished Wundertile installation.

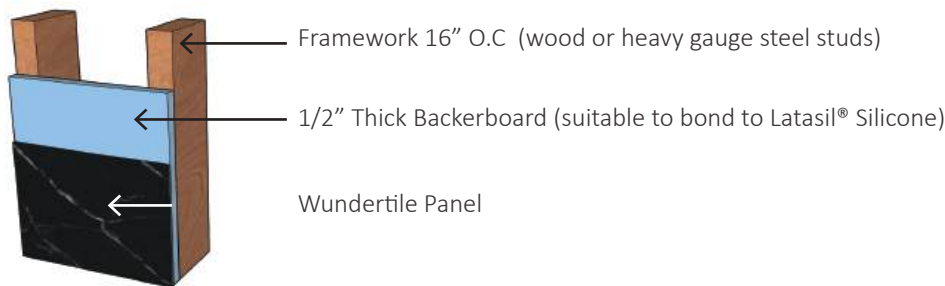

- The finished backerboard surface must be flat to within 1/8" over 6'.
- **Wundertile panels installed in a WET area require a waterproofing backing installed prior to Wundertile installation.** Install Ubertile® Uberboard™ 1/2" thick waterproof backerboard sealed per manufacturers guidelines. Contact www.ubertile.com for more information.
- **Wundertile panels installed in a DRY area DO NOT require a waterproofing backing.**
- Wundertile panels must be fastened using Laticrete® Latasil® silicone.
- Wundertile panels can be installed over existing tile if:
 - The existing tiles have been acid etched & cleaned thoroughly so they do not contain bond breakers, oils, or residuals.
 - The existing tile installation is not water damaged, flat to 1/8" over 6', well bonded, sound, structurally stable and able to support the weight of the Wundertile panels.
- Movement joints using Laticrete® Latasil® silicone must be made at all intersections and/or changes in plane.
- Take care NOT to scratch or damage the product during transport, handling or installation. Though Wundertile panels are durable & long wearing (like the paint on your car) Wundertiles can be scratched with neglect. Claims for scratches in the Wundertile must be made PRIOR to installation and will NOT be accepted after the Wundertile panels have been installed.
- HVAC systems at the jobsite must be installed and fully operational. Wundertiles must be acclimatized for 6 hours prior to installing. The temperature during installation, including during the cure of the silicone, must be between +15 and +30C.

3.1W - How to Cut & Drill



- For straight cuts, use a plunge style Track Saw with the recommended blade:

Tracksaw:

- Festool 491952 Fine Tooth Wood Blade
- Festool 496306 Fine Tooth Aluminium / Plastic Blade
- Or similar blade to cut Non-Ferrous metal

Jigsaw:

- Festool 204337
- Or similar blade to cut Non-Ferrous metal

- For a cleaner cut, it is advised to cut from the BACKSIDE of the panel.
Protect the frontside of the panel from scratches when placing panel face down.



- Securely clamp the Wundertile panel and Cutting Rail when cutting.
- Leave the plastic wrap on the back of the panel while cutting. Once the panel is cut to the desired size, remove the plastic wrap prior to applying adhesive.
- 220 Grit sandpaper can be used to smooth a sharp cut edge.
Be careful not to sand away the printed surface on the face of the Wundertile.
- The factory Wundertile edge has a slight taper.
When joining 2 panels, you can cut off the factory edges off to achieve a taper free edge.

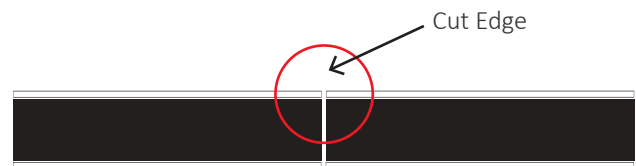
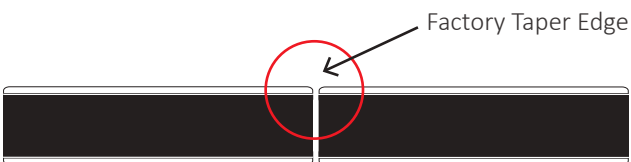

- When drilling, drill from the FRONT side of the panel, this avoids tearing the front layer.
Apply Tape to the area where you will drill the hole, in case your drillbit slips you will not scratch the panel face.
- Use a fine tooth bi-metal hole saw to drill the hole.

4.1W - How to Mitre

Wundertile panel corners can be bent. To do this, milled/router the panel backside.

When bending the Wunderpanels only bend panel once.
If you bend and then rebend the panel the face of the panel will crack.

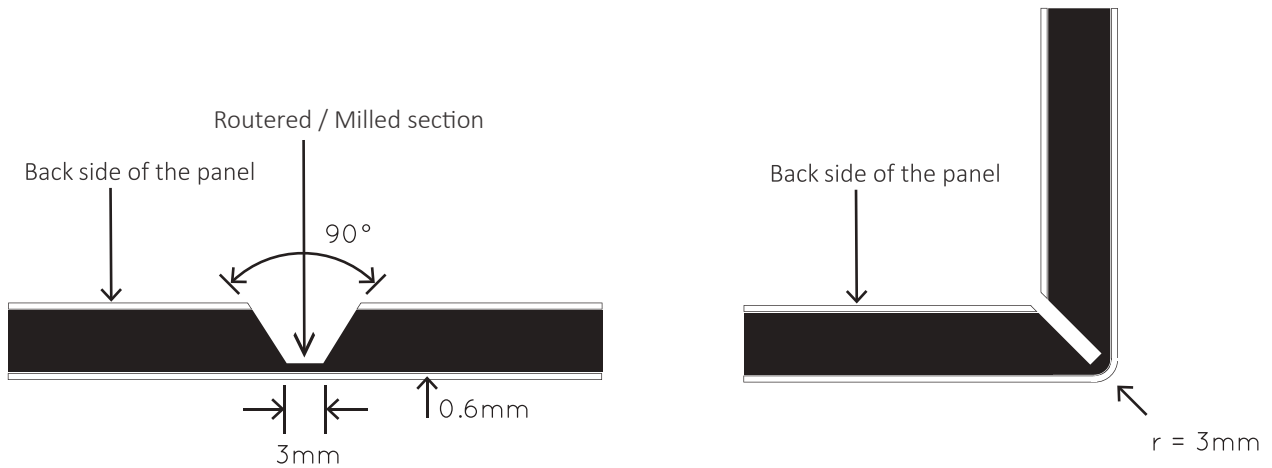

Routing:

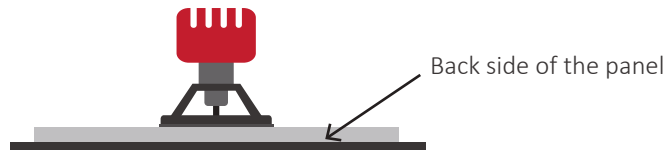

The router must be attached to a track so it runs straight. Use the recommended bits:

- Festool 491444 V-groove router bit
- Or similar router bit

Milling:

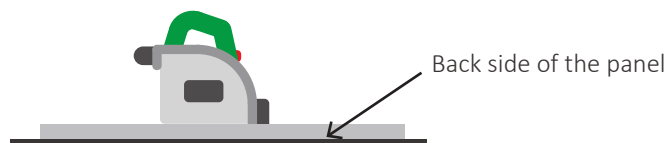

The milling saw must be attached to a track so it runs straight. Use the recommended blades:

- Festool 491470 V-groove milling blade
- Or similar router bit

5.1W - Edge Profiles

- Alternate to bending an outside corner (see section 4.1W), metal edge profiles can be used to finish off the exposed edge of the Wundertile panels.
- To cut metal edge profile, use either a chop saw with a high tooth carbide finishing blade rated for cutting non-ferrous metals, or a metal hack saw blade with a mitre box.
- Fasten metal edge profile using Silco RTV-7500 silicone. Do not staple, screw or nail the metal edge profiles to the wall.

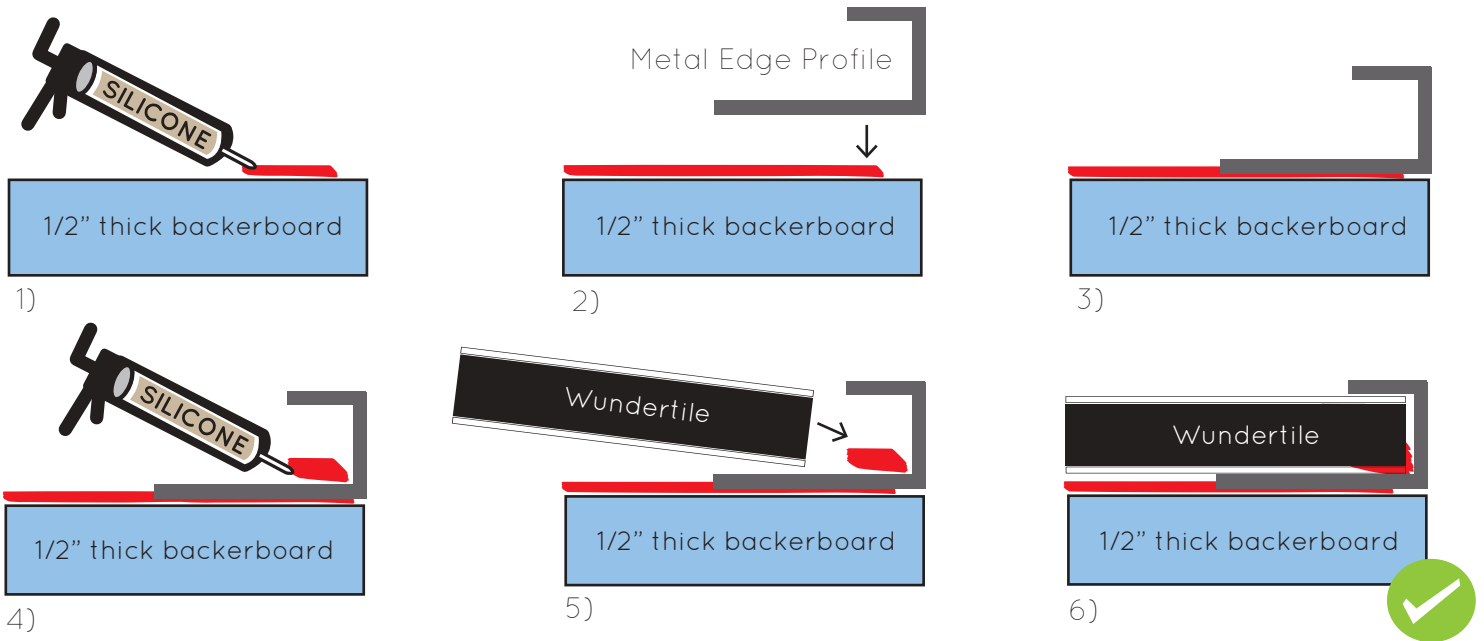

Use the same method as above to finish an outside corner with 2 exposed edges:

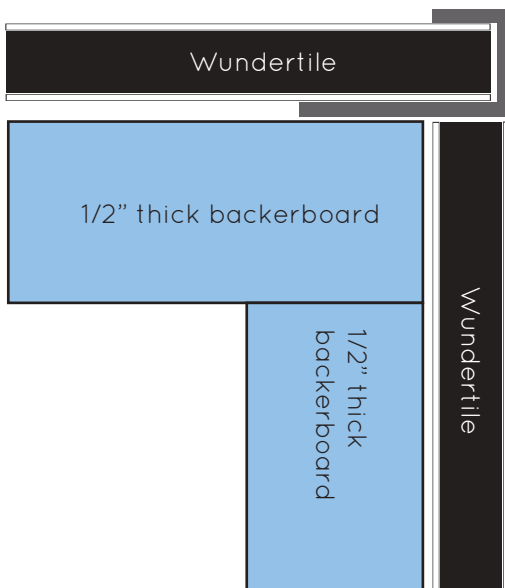

6.1W - How to Adhere



- The back side of the Wundertile has a plastic protective film which **MUST BE REMOVED BEFORE THE SILICONE IS APPLIED!**

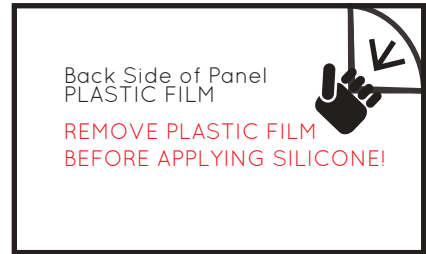

- Use Silco RTV-7500 silicone to adhere panels.**

Coverage of 305mL cartridge = ~40 linear feet @ 4mm sized bead.
Check surface suitability on silicone data sheet.

- Apply silicone onto the back side of the Wundertile panel in straight vertical lines 24" long with 6" gaps between each silicone line, which allows air flow to cure the silicone.
- Apply the silicone rows 6" apart.
Silicone rows should be vertically orientated so water entering can drain.

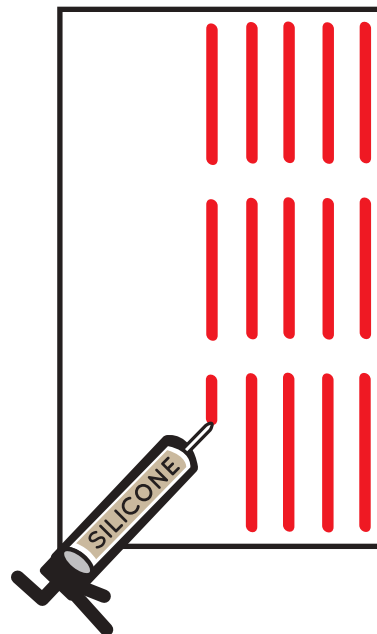
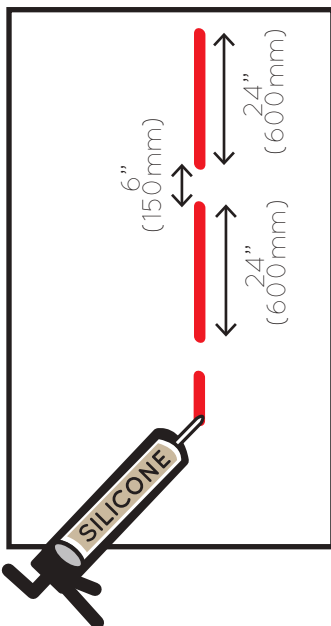
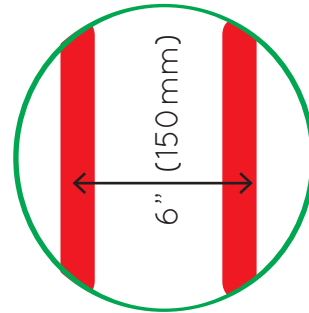
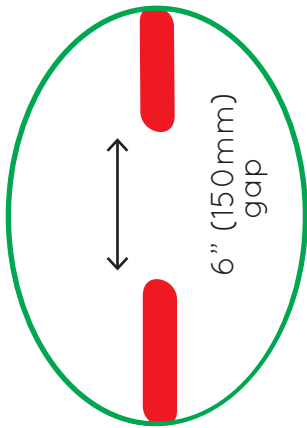

7.1W - Installing Wundertile

- A 1/16" (1.5mm) gap between Wundertile panels is required to allow for expansion & contraction of the wall wood framing / studwork.
- Conditions such as sun exposure (ie windows) and panel color (ie darker colors absorb more heat) require the expansion gap to be larger than 1/16" (1.5mm). Consult engineer for exact expansion gap size to suit site conditions.



- When used in wet areas, the panel gaps must be filled with Laticrete® Latasil® silicone.

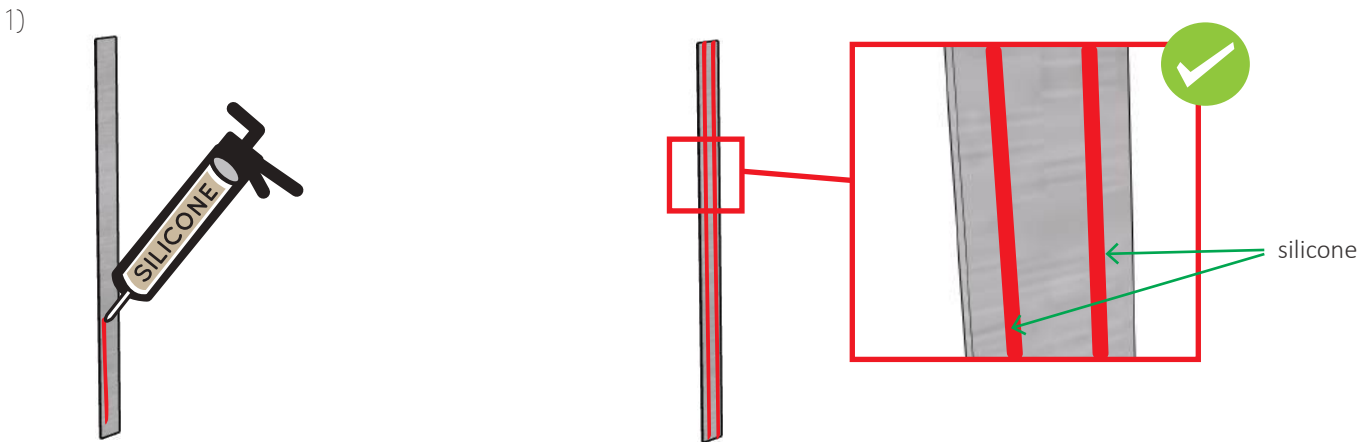

Apply 2 vertical continuous beads of Silco RTV-7500 silicone to the BACK SIDE of the magnetic aligning strip.

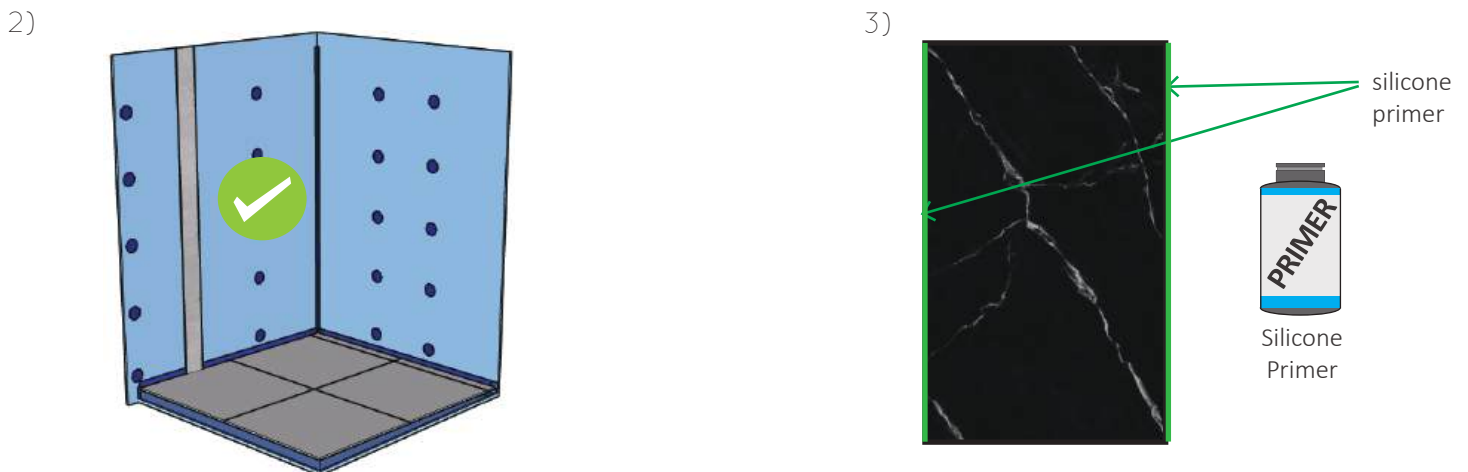

With the silicone still wet, the magnetic aligning strip is placed onto the backerboard, in the middle of where the wundertile seam will be located.

Apply silicone primer onto exposed 3mm edges of Wundertile panel. Apply per silicone primer manufacturer instructions.

7.1W - Installing Wundertile (continued)

4)

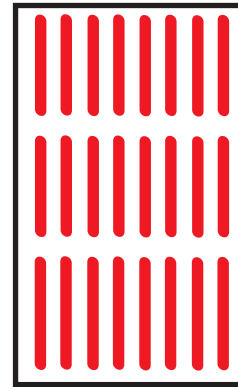
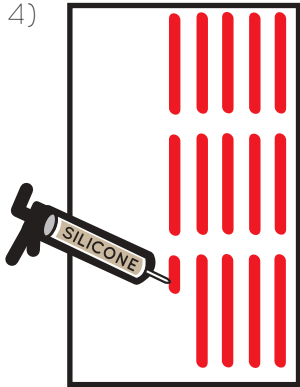

Apply Silco RTV-7500 to the BACK SIDE of the Wundertile panel, in continuous beads 4-6" (10-15cm) apart.

5)

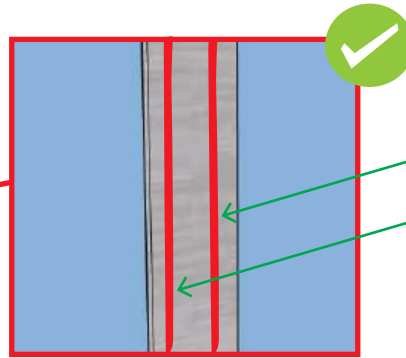
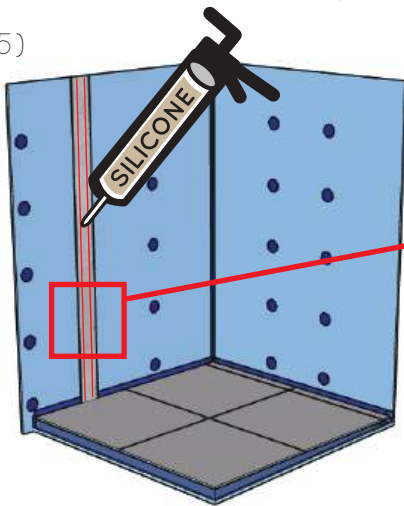

silicone

Apply 2 continuous vertical beads of Silco RTV-7500 onto the FRONT SIDE of the magnetic aligning strip.

6)

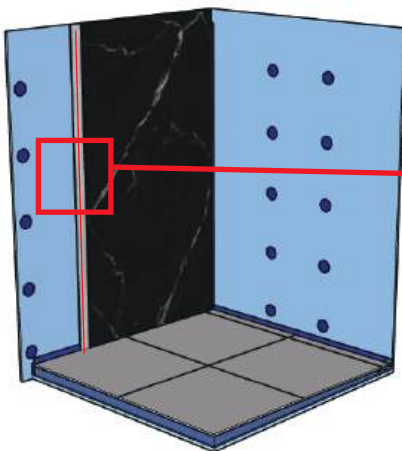

Silco RTV-7500

middle of magnetic strip

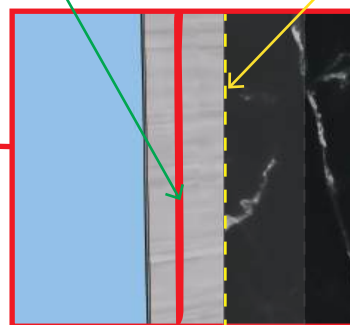

7)

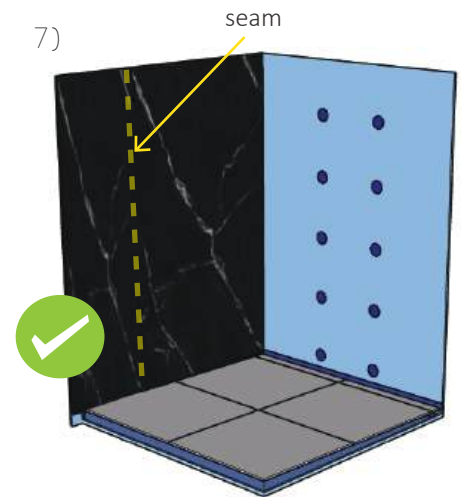

seam

With the Silco RTV-7500 still wet, install Wundertile panel, pressing firmly into position, with the Wundertile seam positioned in the middle of the magnetic strip.

With silicone still wet, install second Wundertile using same method as above.

7.1W - Installing Wundertile (continued)

8)

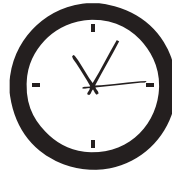
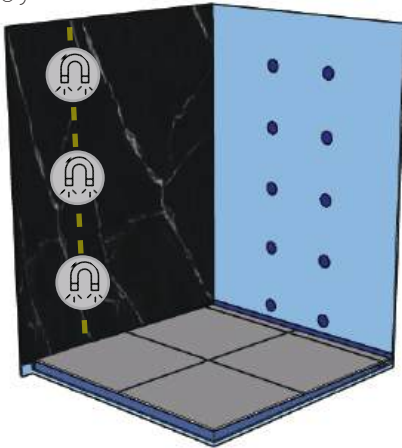

Allow Silicone to cure before removing magnet.

With the silicone fresh, place magnets over the top of the seam to make panels flush. Do not scratch the surface of the panel with magnets. When silicone is cured, remove magnets.

9)

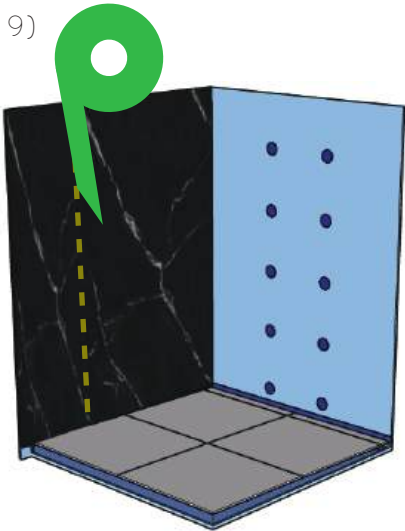

10)



Apply painters tape at the panel seams so silicone is overlapping 1/16" (1.5mm) onto each panel surface. This will allow better adhesion of the silicone.

11)

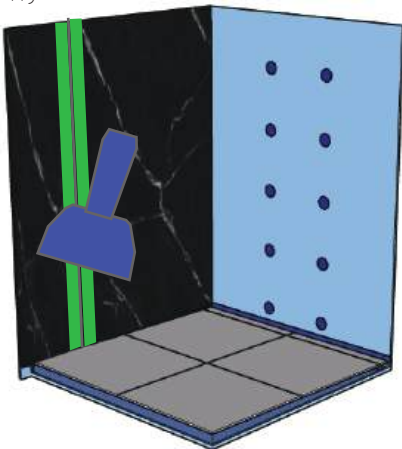

12)

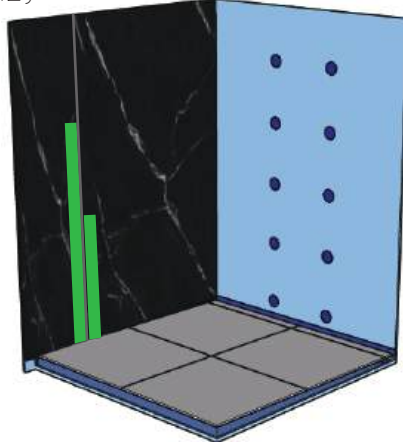

Spread silicone with spreading tool. With silicone still wet, remove tape. Continue installing additional panels until installation is completed.

Joints must be filled using Laticrete® Latasil® silicone at all intersections and/or changes in plane of the Wundertile panels.

8.1W - Cleaning & Maintenance

- Clean Wundertiles using a soft non-abrasive cloth with water and an alkaline detergent cleaner (ph 7 - 12) is intended for cleaning. Rinse with clean water.
- Do NOT use cleaning agents or cleaning tools such as scouring agents or scouring pads which have aggressive or abrasive components, are acidic, contain paint thinners, and or mineral spirits or similar .
- Take care NOT to scratch or damage the product during transport, handling, installation or during post installation care.
- Wundertile panels are durable & long wearing (like the paint on your car), however in that regard Wundertiles can be scratched with neglect.
- Claims for scratches in the Wundertile must be made PRIOR to installation and will NOT be accepted after the Wundertile panels have been installed.
- Changes in gloss level, dulling, minor scratches, scuffing, chipping, and or other normal wear-and-tear of the Wundertile surface is considered normal over the lifespan of the the Wundertile, meaning the surface will have an appearance that changes in relation with age.

9.1W - Warranty

The Wundertile panels are covered by the Wundertile 10 year Limited Warranty Document, which is available to view at www.wundertile.ca